

■ BN44 Series (Inner Rotor Type Brushless Motor)

New Model

- Features**
- High Efficiency, High Power
 - Low Mechanical Noise
 - Quick Response, Long Life

- Application**
- Industrial Machines
 - Office Machines
 - Cash Handling Machines

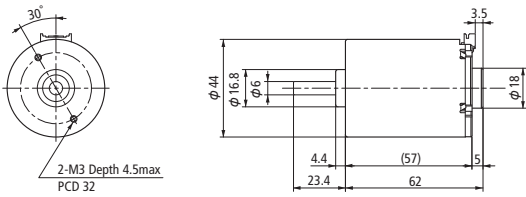

MODEL	Rated Voltage	Rated Power Output	Rated Torque	Rated Speed	Rated Current	No Load Speed	No Load Current	Starting Torque	Torque Constant	Winding Resistance	Winding Inductance	Moment of Inertia	Mechanical Time Constant	Thermal Resistance
	V	W	mN·m(gf·cm)	r/min	mA	r/min	mA	mN·m(gf·cm)	mN·m/(gf·cm/A)	Ω	mH	g·cm ²	ms	°C/W
BN44	24	18.5	49 (500)	3600	1200	4700	---	---	53.9 (550)	1.7	---	25	---	---

■ BN44+Encoder

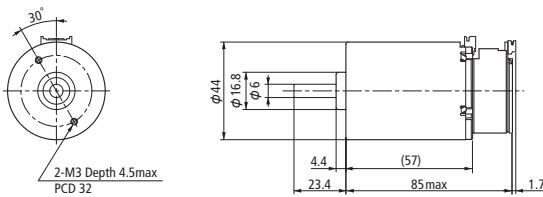

MODEL(Phases)	Input Voltage	Number of Pulses	Response Frequency	Encoder Type	Output Level	Index Pulse Width	Logic Width	Duty Ratio	Output Signal Form
	V	P/R	KhZ(MAX)						
BP44(2)	5	512	40	Optical	TTL	---	S=90° e±30°e	30%~70%	Square Wave
BP44(2)	5	1000	50	Optical	TTL	---	S=90° e±15°e	40%~60%	Square Wave

※BP44 model means BN44 with encoder. 3 Phase encoder model is available.