

# ■ DN22 S + Gear Head (Planetary Gear) ■ DN22 + Gear Head (Planetary Gear)

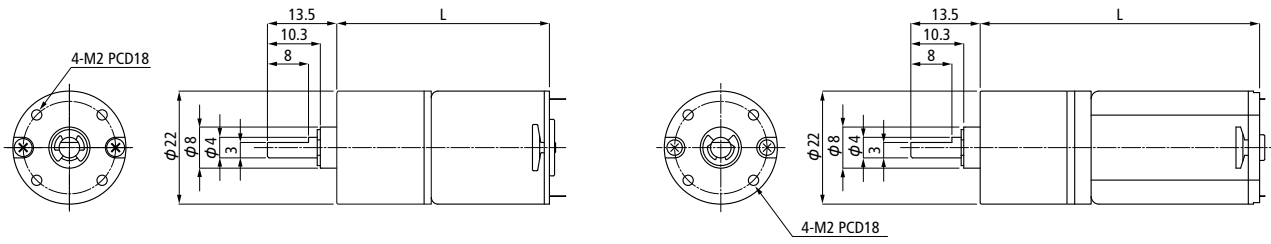

MODEL(Gear Ratio)	Rated Voltage	Rated Torque	Rated Speed	Rated Current	No Load Speed	No Load Current	Total Length
	V	mN·m(gf·cm)	r/min	mA	r/min	mA	mm
DG22 S (1/ 20)	6	29.4 (300)	410	520	510	160	37.7
	12	29.4 (300)	450	330	540	120	37.7
DG22 S (1/ 62)	6	78.5 (800)	135	510	165	160	41.4
	12	78.5 (800)	145	320	170	120	41.4
DG22 S (1/107)	6	98.1 (1000)	85	410	95	160	41.4
	12	98.1 (1000)	90	270	100	120	41.4
DG22 S (1/242)	6	147.0 (1500)	38	340	43	160	45.1
	12	147.0 (1500)	40	230	45	120	45.1
DG22 S (1/410)	6	196.0 (2000)	23	300	25	160	45.1
	12	196.0 (2000)	25	210	27	120	45.1
DG22 (1/ 20)	12	29.4 (300)	355	230	405	80	50.7
	24	29.4 (300)	350	110	400	40	50.7
DG22 (1/ 62)	12	78.5 (800)	115	230	140	80	54.4
	24	78.5 (800)	115	130	135	40	54.4
DG22 (1/107)	12	98.1 (1000)	70	170	76	80	54.4
	24	98.1 (1000)	80	100	75	40	54.4
DG22 (1/242)	12	147.0 (1500)	31	160	33	80	58.1
	24	147.0 (1500)	30	90	33	40	58.1
DG22 (1/410)	12	196.0 (2000)	19	130	20	80	58.1
	24	196.0 (2000)	19	65	20	40	58.1

DG22 : DN22+Gear Head