

■ LN12 + Gear Head (Planetary Gear)

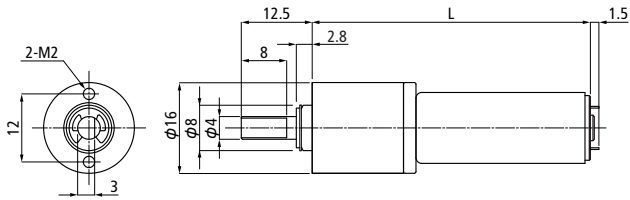

MODEL(Gear Ratio)	Rated Voltage	Rated Torque	Rated Speed	Rated Current	No Load Speed	No Load Current	Total Length
	V	mN · m(gf · cm)	r/min	mA	r/min	mA	mm
LG12 (1/ 20)	6	11.8 (120)	415	180	455	55	49.1
LG12 (1/ 62)	6	29.4 (300)	135	170	145	65	52.8
LG12 (1/ 107)	6	49.1 (500)	80	170	85	65	52.8
LG12 (1/ 242)	6	98.1 (1000)	35	170	37	75	56.5
LG12 (1/ 410)	6	147.0 (1500)	20	160	22	75	56.5

LG12 : LN12+Gear Head