

# ■ LN18 + Gear Head (Planetary Gear)

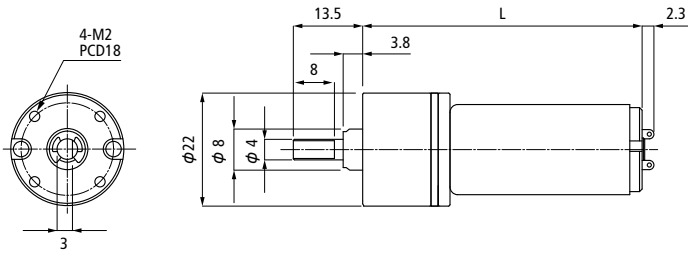

MODEL(Gear Ratio)	Rated Voltage	Rated Torque	Rated Speed	Rated Current	No Load Speed	No Load Current	Total Length
	V	mN·m(gf·cm)	r/min	mA	r/min	mA	mm
LG18 (1/ 20)	12	29.4 (300)	355	170	375	45	54.4
LG18 (1/ 62)	12	78.5 (800)	115	165	120	45	58.1
LG18 (1/ 107)	12	98.1 (1000)	68	130	70	45	58.1
LG18 (1/ 242)	12	147.0 (1500)	30	110	31	50	61.8
LG18 (1/ 410)	12	196.0 (2000)	18	100	19	50	61.8

LG18 : LN18+Gear Head